



**WARNING:** THE FAILURE TO FOLLOW THESE INSTRUCTIONS WHEN INSTALLING THE LED BEACONZ™ MAY CAUSE ELECTRIC PROBLEMS IN YOUR VEHICLE WHICH COULD CAUSE VEHICLE DAMAGE, ELECTRICAL SYSTEM DAMAGE, FIRE, ELECTRICAL SHOCK, PERSONAL INJURY OR DEATH.

DO NOT LOOK DIRECTLY INTO THE LED BEACONZ™. DO NOT DRIVE OR POSITION YOUR VEHICLE NEAR ONCOMING TRAFFIC WHEN THE LED BEACONZ™ IS POWERED ON – DOING SO MAY RESULT IN VISION IMPAIRMENT AND OR VEHICULAR COLLISION. THE INTENDED USE OF THE LED BEACONZ™ IS TO PROVIDE EXTERIOR AUXILIARY LIGHTING FOR OFF ROAD USE ONLY WHEN PROPERLY INSTALLED IN A 12-24V AUTOMOTIVE SYSTEM. THIS PRODUCT IS NOT DOT APPROVED.

### INSTALLATION GUIDELINE

LED Beacons™ is an auxiliary light designed to provide exterior auxiliary and accent lighting while driving off road. LED Beacons™ has a distinct amperage draw below in the installation instructions. If you are not confident in your ability to install the BriteLED™ LED Beacons™ please consult a licensed mechanic.

LED Beacons™ has specific voltage and amperage ratings for power input and amperage draw. ENSURE THESE RATINGS ARE FOLLOWED. The LED Beacons™ must be installed in a properly functioning vehicle electrical system. Do not install this product in a malfunctioning vehicle electrical system.

Select a mounting location that will not obstruct the operation of headlights or turn signals

Clean mounting surfaces before installing units using water, and if necessary, a 50/50 mix of water and rubbing alcohol

Before permanently mounting to vehicle, test fit to ensure optimal beam pattern, height, and width and that wiring is long enough to be safely installed and does not obstruct any operating functions of the vehicle. These lights should not be installed wherein operation hinders the visibility of the driver or other drivers

During operation lighting units can get hot - do not touch while operational or within 30 minutes of powering down.

It is recommended that you consult your vehicle owner's manual to determine the location of airbag sensors before installation. The manufacturer or the retailer is not responsible for inflation of airbags or damage to airbag sensors due to the installation of this product.

Before disconnecting battery terminals, please check your owner's manual for proper procedure

## INSTALLATION INSTRUCTIONS

**WARNING**

BE SURE TO USE SAFETY GLASSES AT ALL TIMES WHEN INSTALLING THIS PRODUCT.

**1** CUT BLACK BAND

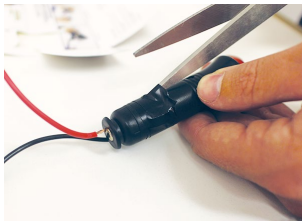

**2** DISCONNECT BLACK WIRE

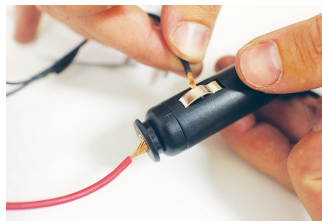

**3** UNSCREW CAP AND DISCONNECT RED WIRE

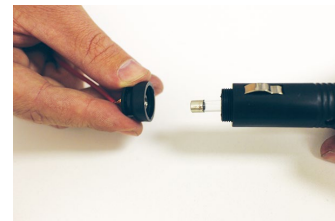

**4** REATTACH CAP ENSURING FUSE IS PROPERLY IN PLACE.



**5** ENSURE ROOF SURFACE IS CLEAN BEFORE MOUNTING.

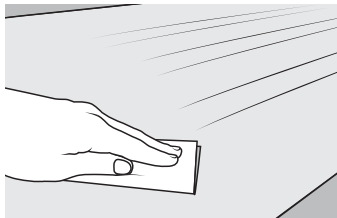

**6** MOUNT LED BEACONZ™ TO DESIRED SURFACE OF VEHICLE, ENSURING MAGNETIC BASE IS SECURE.



**7** INSERT POWER PLUG INTO A CIGARETTE LIGHTER OR A 12V-24V POWER OUTLET

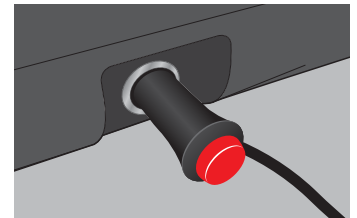

**8** USE BUTTON ON 12V-24V PLUG TO TOGGLE POWER.

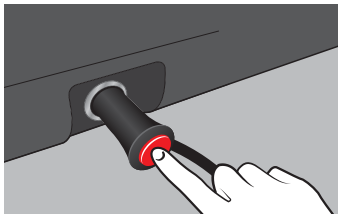

**9** WHEN REMOVING LED BEACONZ™, PULL UPWARDS AND DO NOT DRAG THE BASE ALONG ANY SURFACE.



### WARRANTY

The manufacturer warrants this LED Beacons™, when it is properly installed, connected and operated, for a period of 1 year from the date of purchase.

The warranty is void and neither the manufacturer nor the retailer is responsible for any product failure, damage or injury if these instructions are not strictly followed.